

# GRAVES CONCRETE

Blocks are made with returned concrete

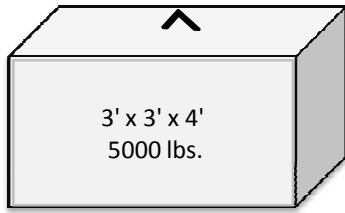

3' x 3' x 4'  
5000 lbs.

\$50.00

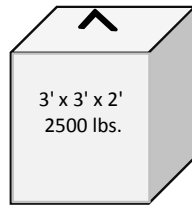

3' x 3' x 2'  
2500 lbs.

\$40.00

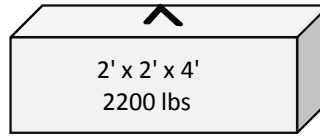

2' x 2' x 4'  
2200 lbs

\$45.00

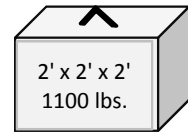

2' x 2' x 2'  
1100 lbs.

\$40.00

## UnFaced V-Groove Blocks

Blocks are made with returned concrete

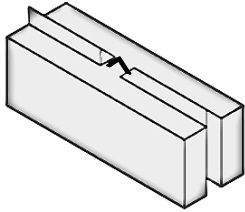

2' x 2' x 6'  
3150 lb.  
\$60.00

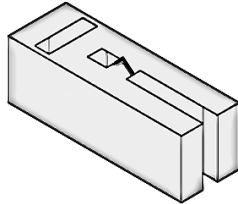

2' x 2' x 5'  
2600 lbs.  
\$60.00

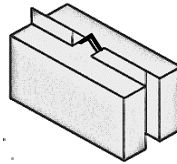

2' x 2' x 4'  
2100 lbs.  
\$55.00

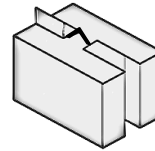

2' x 2' x 2'  
2' x 2' x 3'  
1570 lbs.  
\$40.00 & 50.00

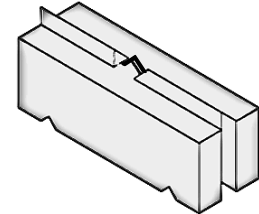

2' x 2' x 6' corner  
3140 lbs.  
\$60.00

## Faced V-Groove Blocks

Blocks are made with returned concrete

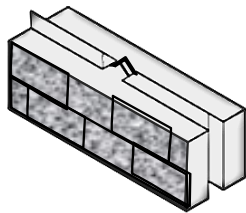

2' x 2' x 6'  
3150 lb.  
\$70.00

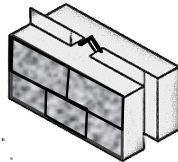

2' x 2' x 4'  
2100 lbs.  
\$65.00

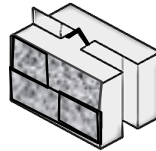

2' x 2' x 2'  
2' x 2' x 3'  
1570 lbs.  
\$50.00 & 60.00

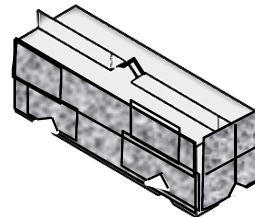

2' x 2' x 6' corner  
3140 lbs.  
\$70.00

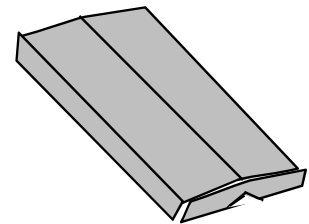

26" x 6" x 6' Cap  
1050 lbs.  
\$85.00  
4000 psi



Retaining Wall Blocks  
16" high x 48" long

Made with 4000psi  
Concrete

24" Deep Block \$85.00  
39" Deep Block \$95.00  
45" Deep Block \$105.00  
60" Deep Block \$115.00  
72" Deep Block \$125.00



Top Block \$80.00  
Corner Block \$85.00  
Half Blocks \$75.00  
Cap Stone \$75.00  
Step \$75.00

Graves Concrete  
P.O. Box 680 E. Templeton, MA.01438 978-939-5712 ext. 3